

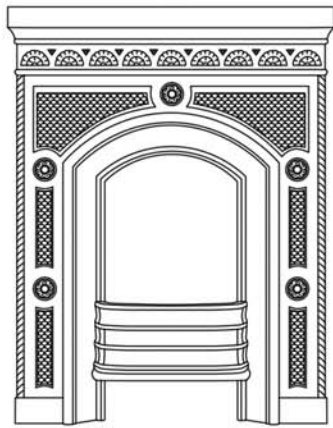

## The Hawthorne Combination

### Contents



Fireplace Fascia



Shelf

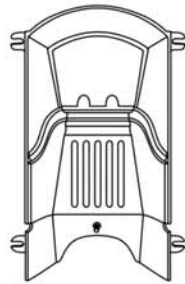

Fireplace Back

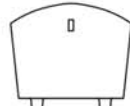

Damper Plate



Grate



Ashpan Cover



Ashpan Handle

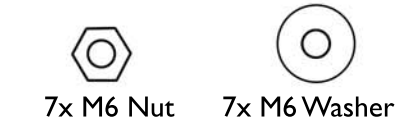
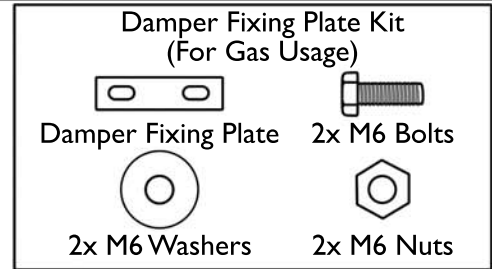

Please note, a flat head screwdriver and spanner are required to assemble this fireplace.

1

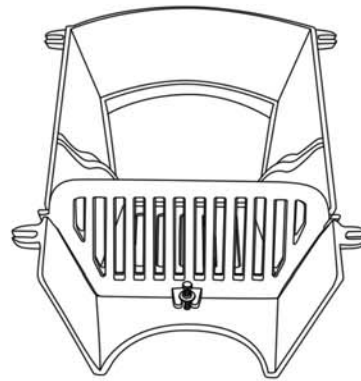
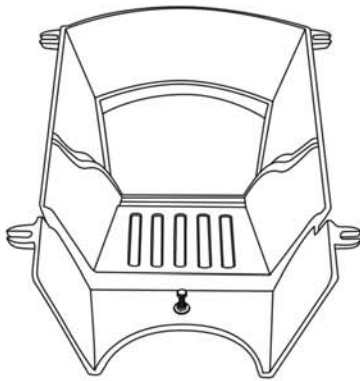

Lay Fireplace Back down on level ground. Position Firebrick in place and then insert 1 x M6 Stud into the hole just below the Firebrick. Insert Grate into the groves on the Fireplace Back, passing the fixing lug over the M6 Stud. Secure in place with 1 x M6 Washer and 1 x M6 Bolt.

THIS STEP IS NOT REQUIRED FOR GAS USAGE.

2

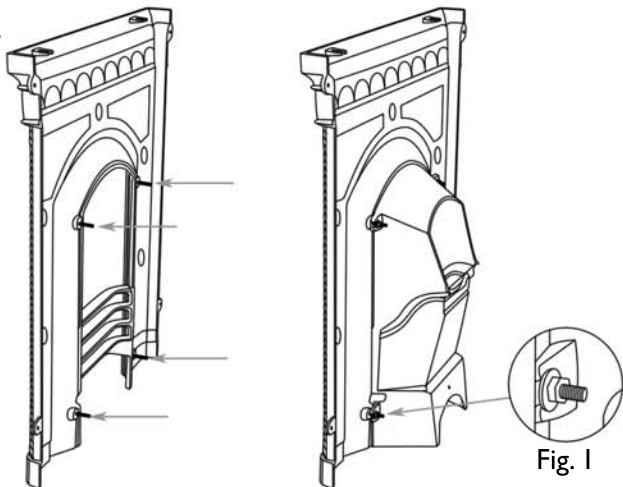

Insert the 4 M6 Studs into the back of the Fireplace Fascia. Attach Fireplace Back to the back of the Fireplace Fascia, ensuring that the M6 Studs pass through the fixing brackets on the Fireplace Back. Secure and tighten using 4 M6 Washers and 4 M6 Nuts.

3

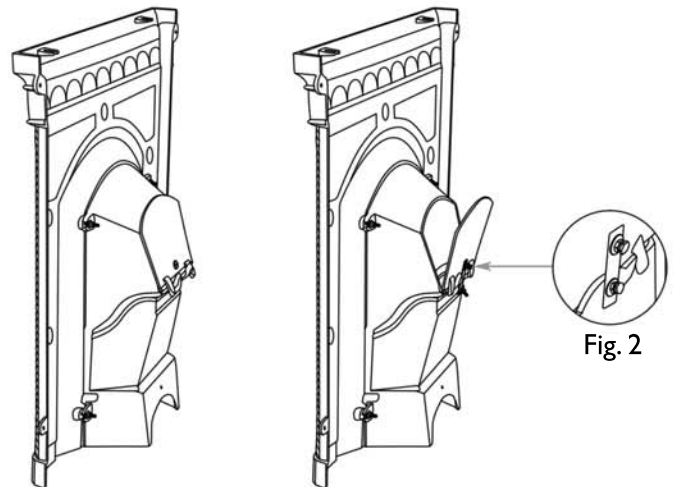

Solid Fuel Usage: Rest the Damper Plate onto the groove on the back of the Fireplace Fascia.  
Gas Usage: The Damper Plate must remain fixed open for Gas Usage by using the Damper Plate fixing Kit. Screw M6 Nut fully onto M6 Bolt and lastly M6 washer x2. Attach Damper Fixing Plate as fig 2.



## The Hawthorne Combination

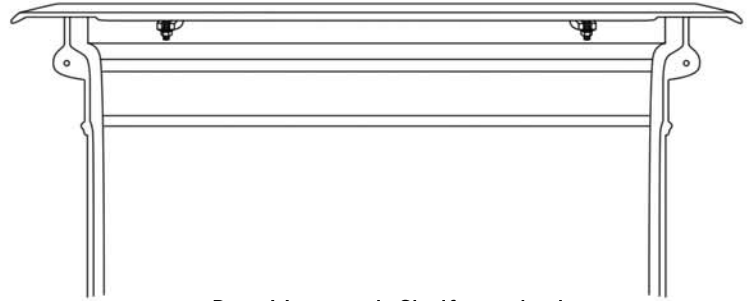
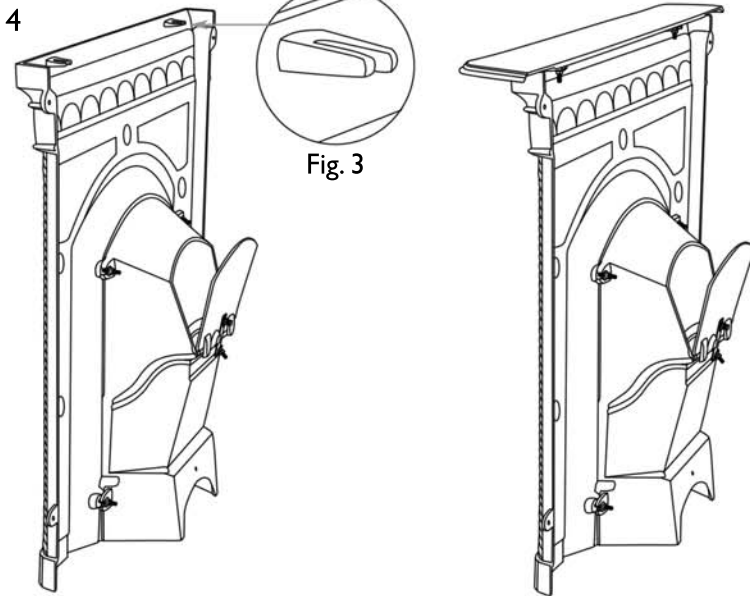

Rear View with Shelf attached

Lay Shelf upside down on floor. Loosely insert 2x M6 Studs, firstly passing through 2x M6 Washers. Place 2x M6 Nuts onto the ends of the 2x M6 Studs.

Attach shelf to Fireplace Fascia passing the 2x M6 Studs through the fixing lugs (Fig. 3). The washers should be below the fixing lugs. Tighten and secure with 2x M6 Nuts.

5

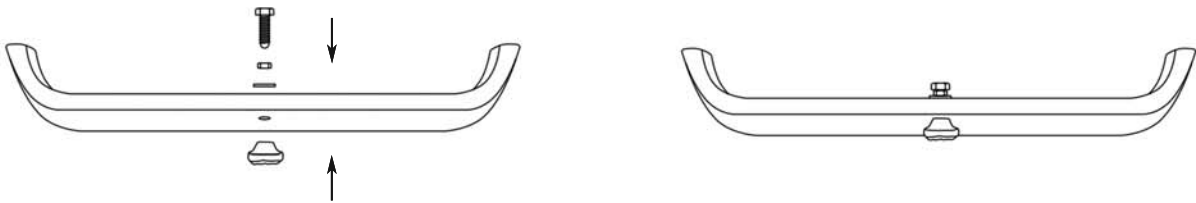

Attach the Ashpan Handle to the Ashpan using 1x M6 Bolt, 1x M6 Washer and 1x M6 Nut.

6

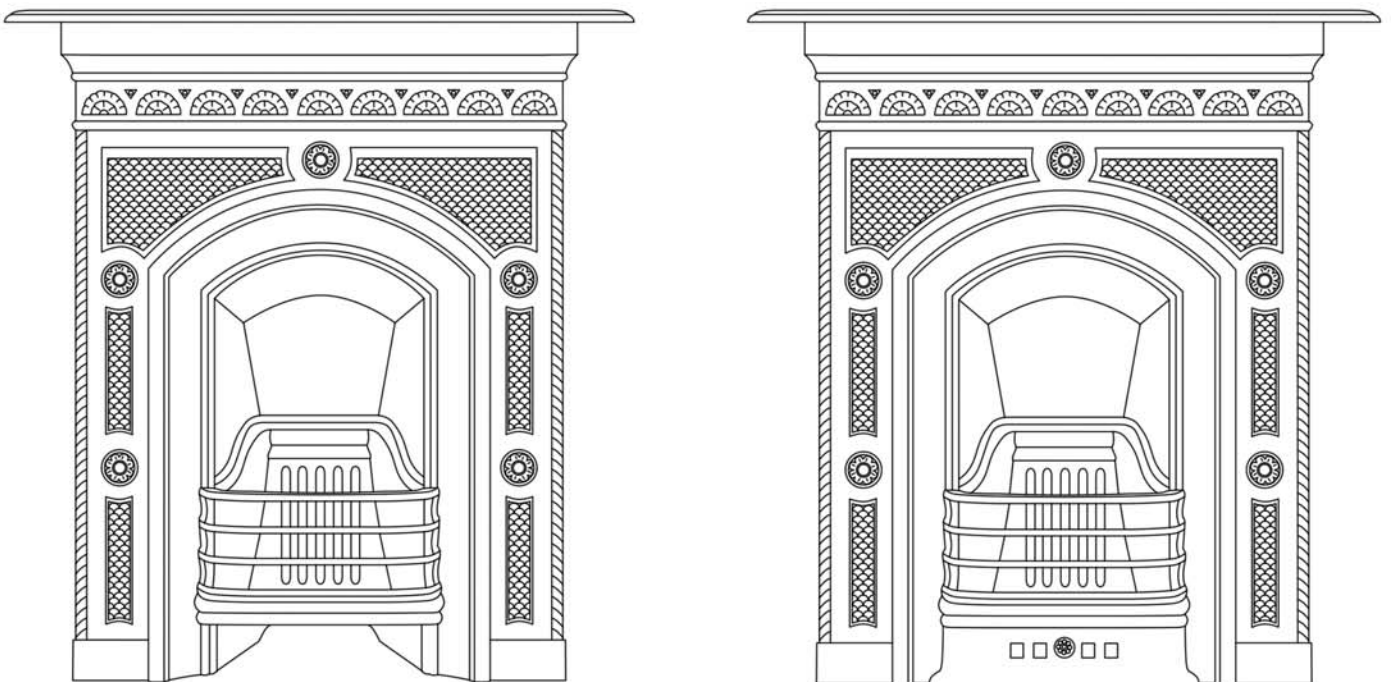

To complete, place Ashpan Cover below Grate and Bars on the front of the Fireplace.